

# OxyHolter Hook-up Guide

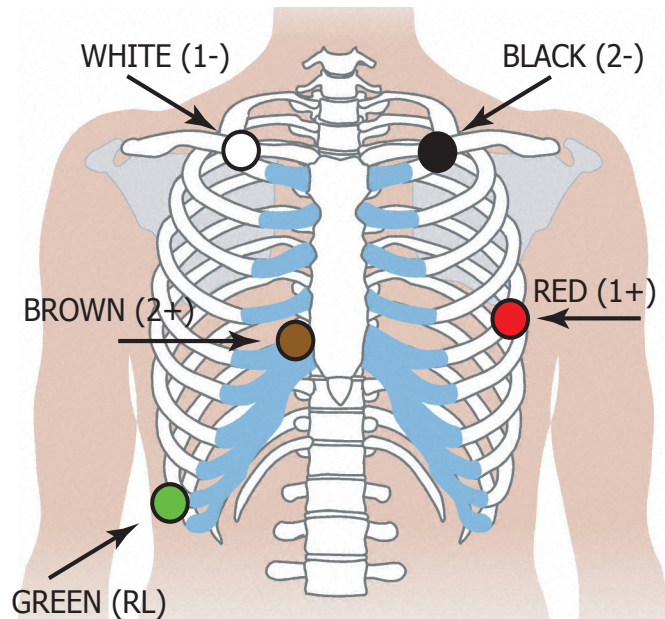

## Electrodes

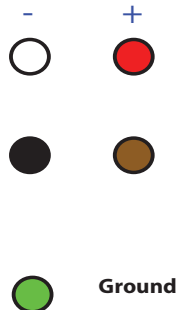

## Placement

Ch. 1 mod.V5	Ch. 1:	White: Right shoulder, mid-clavicular Red: 5th left intercostal space
Ch. 2 mod.V1	Ch. 2:	Black: Left shoulder, mid-clavicular Brown: Right of xyphoid process
Ground		Green: Right, bottom of ribs

## Patient Preparation

- Select area over bone, avoiding muscle areas and breast tissue.
- Clean electrode sites aggressively with alcohol and use a razor to remove hair.
- Abrade electrode sites with a scrub pad or gauze. Allow sites to dry before applying electrodes.
- Firmly snap electrodes to the lead wires.
- Apply electrodes to appropriate sites. Press adhesive border firmly for consistent adhesion.
- To help alleviate tension, loop and tape lead wires down.



- Remove the backing from the finger wrap and attach the oximetry probe to its sticky side, lining up the two bumps on the probe with the cutouts in the wrap.
- Position the patient's finger on the probe. Be sure to line up the tip of the finger with the center line on the wrap.

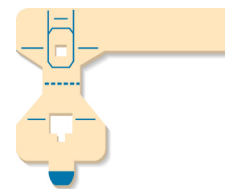

- Attach the wraps to the patient's finger in this order:

Attach the two small side wings;  
Fold the wrap and probe back over the fingernail;  
Wrap the third small wing;  
Wrap the long wing around the finger.

- Use tape around the base of the patient's finger to secure the cable.

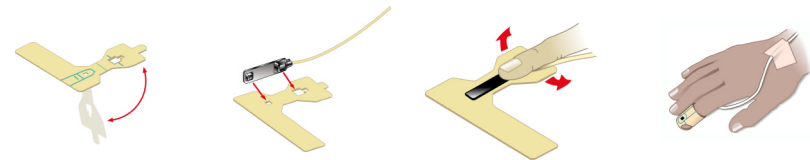

2 Clock Tower Place, Suite 555 Maynard, MA 01754  
toll free: 866-346-5837 phone: 978-461-3992 fax: 978-461-5837  
www.nemon.com

# Quick DR180+ OxyHolter Setup Guide

## Step 1

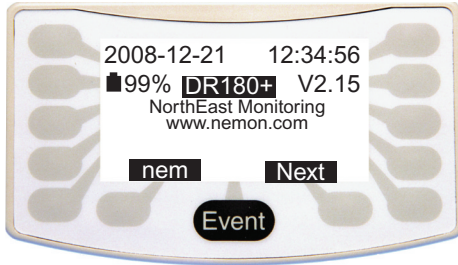

1. With the oximetry cable already connected to the recorder, insert the compact flashcard into the recorder.
2. Insert 2 alkaline or NiMH batteries. Battery level should be at least 95%.
3. Press **Next**.

## Step 2

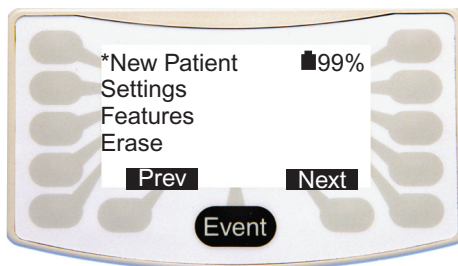

1. Press **Next** or **New Patient**.
- ▶ Press **Settings** to change the time, date, language, battery type, inverted display, daylight savings and mode lock.

## Step 3

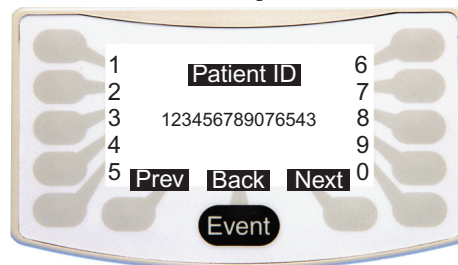

1. Enter *Patient ID* (up to 20 digits).
2. Press **Next**.

## Step 4

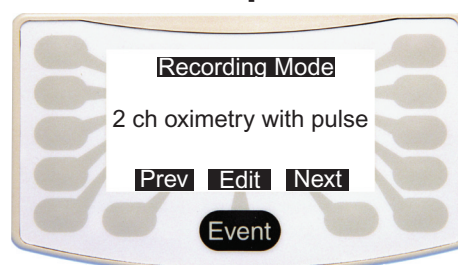

- ▶ For oximetry, confirm the correct *Recording Mode*. Press **Edit** to change the mode.
1. Press **Next**.

## Step 5



1. Lead Quality, or impedance, should be 4 or 5 for Channels 1 and 2. Ch 3 should read SpO2.
- ▶ If Ch 3. reads "no cable," the oximetry cable is not attached correctly. Reconnect and wait for display to read SpO2.
2. Press **Next**.

## Step 6

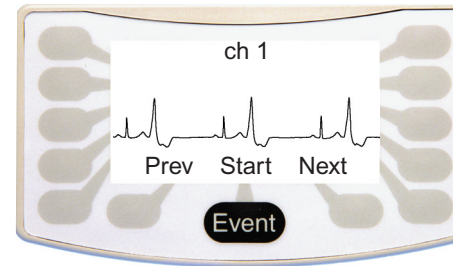

1. Press **Next** to cycle through the channels.
2. Press **Start** to begin recording.

## Step 7



**DONE!**

- ▶ See Step 2 to invert the display.